

STATE OF NORTH CAROLINA
DEPARTMENT OF TRANSPORTATION
HIGHWAY DIVISION 6

PLANS
January 5, 2017

CONTRACT ID: DF00149
WBS ELEMENT NO.: 2017CPT.06.09.20782.1 & 2017CPT.06.09.20782.2
FEDERAL AID NO.: STATE FUNDED
COUNTY: ROBESON
TIP NO.: -----
LENGTH OF PROJECT: 63.694 MILES
ROUTE NO.: VARIOUS SECONDARY ROUTES
TYPE OF WORK: ASPHALT SURFACE TREATMENT – DOUBLE & TRIPLE SEALS

Robeson County BST 2018

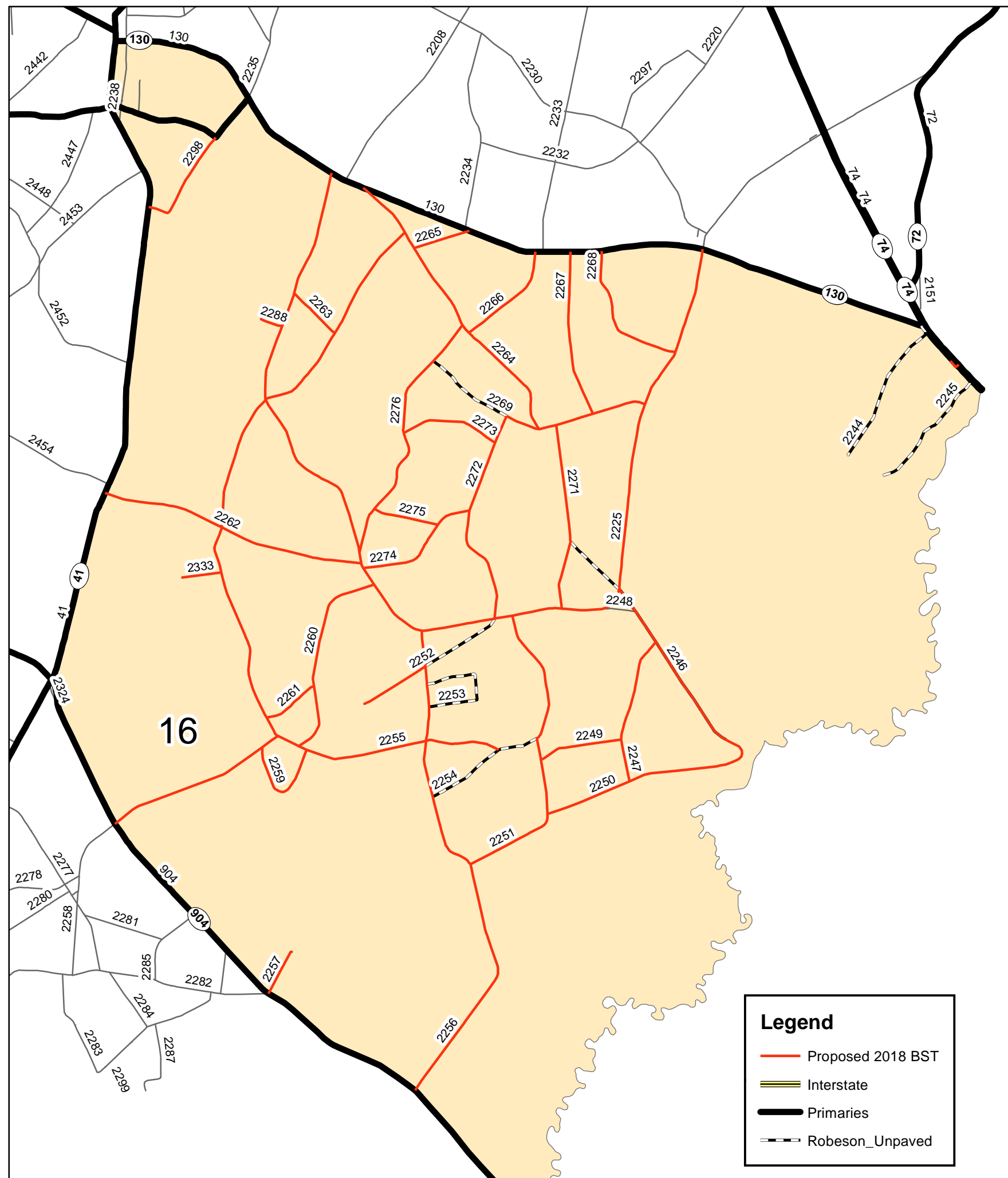

Legend

- Proposed 2018 BST
- Interstate
- Primaries
- Robeson_Unpaved

Number	Rating	AADT	From Description	To Description	From	To	Length	Width	Yards	Seal
SR 2225	78.5	1500	NC 130	NC 130	3.050	14.171	11.121	20	130,486	Double
SR 2246	88.4	120	SR 2225	SR 2247	0.690	4.013	1.443	20	16,931	Double
SR 2247	42.0	120	SR 2246	SR 2250	0.000	1.510	1.510	20	17,717	Triple
SR 2249	85.1	60	SR 2247	SR 2251	0.000	0.850	0.850	20	9,973	Double
SR 2250	88.4	100	SR 2247	SR 2251	0.000	0.900	0.900	20	10,560	Double
SR 2251	75.2	120	SR 2225	SR 2249	0.000	3.120	3.120	18	32,947	Double
SR 2252	92.5	10	SR 2256	CDS	0.860	1.600	0.740	20	8,683	Double
SR 2255	62.5	100	SR 2254	SR 2264	0.000	8.280	8.280	20	97,152	Double
SR 2256	71.9	430	SR 2225	NC 904	0.000	5.140	5.140	18	54,278	Double
SR 2257	57.2	10	NC 904	DEAD END	0.000	0.500	0.500	20	5,867	Double
SR 2258	68.4	270	NC 904	SR 2255	1.690	3.590	1.900	18	20,064	Double
SR 2259	66.4	100	SR 2255	SR 2258	0.000	1.040	1.040	18	10,982	Double
SR 2260	81.7	200	SR 2255	SR 2225	0.000	2.060	2.060	18	21,754	Double
SR 2261	83.0	0	SR 2255	SR 2260	0.000	0.590	0.590	20	6,923	Double
SR 2262	81.8	300	SR 2225	NC 41	0.000	2.730	2.730	20	32,032	Double
SR 2263	98.0	50	SR 2225	SR 2255	0.000	0.579	0.579	20	6,794	Double
SR 2264	85.1	400	NC130	SR 2269	0.000	3.110	3.110	18	32,842	Double
SR 2265	54.3	120	SR 2264	NC 130	0.000	0.590	0.590	20	6,923	Double
SR 2266	85.1	200	SR 2264	NC 130	0.000	1.120	1.120	18	11,827	Double
SR 2267	85.1	150	NC130	SR 2269	0.000	1.700	1.700	18	17,952	Double
SR 2268	100.0	50	NC 130	SR 2225	0.000	1.470	1.470	20	17,248	Double
SR 2269	91.7	100	SR 2225	SR 2272	0.000	1.480	1.480	18	15,629	Double
SR 2271	88.4	200	SR 2225	SR 2269	0.000	1.890	1.890	18	19,958	Double
SR 2272	81.8	100	SR 2269	SR 2225	0.000	2.240	2.240	18	23,654	Double
SR 2273	95.0	30	SR 2272	SR 2276	0.000	1.020	1.020	20	11,968	Double
SR 2274	96.7	120	SR 2272	SR 2225	0.000	1.330	1.330	18	14,045	Double
SR 2275	96.7	40	SR 2276	SR 2274	0.000	0.670	0.670	20	7,861	Double
SR 2276	91.7	200	SR 2225	SR 2264	0.000	2.690	2.690	18	28,406	Double
SR 2288	100.0	40	SR 2225	DEAD END	0.000	0.233	0.233	20	2,734	Double
SR 2298	54.0	800	NC 41	NC 130	0.000	1.120	1.120	18	11,827	Double
SR 2312	87.5	30	US 74	DEAD END	0.000	0.118	0.118	20	1,385	Double
SR 2333	100.0	10	SR 2255	CDS	0.000	0.410	0.410	20	4,811	Double

Total Miles = 63.694

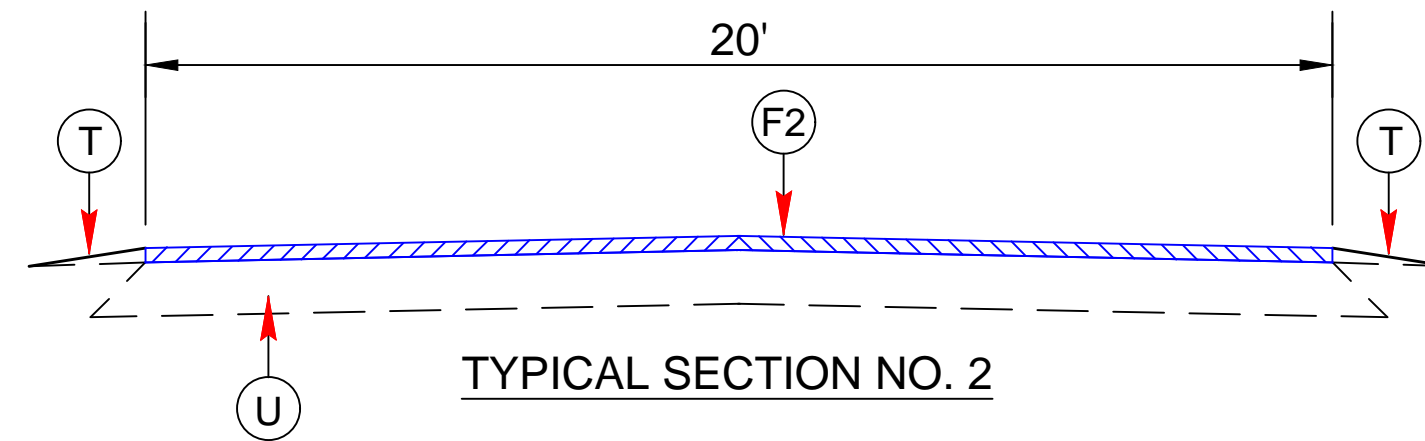
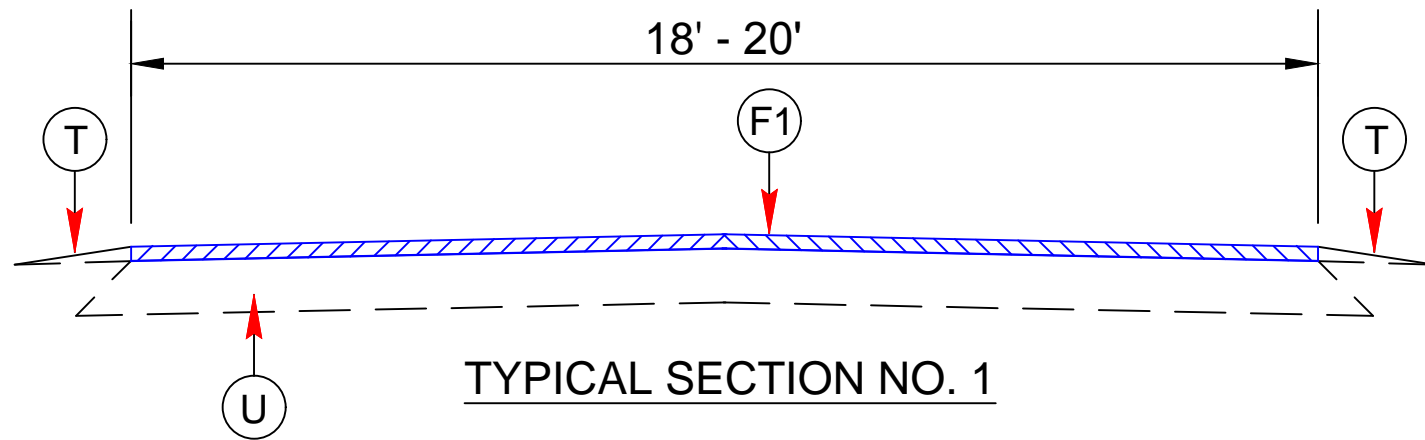

PAVEMENT SCHEDULE	
F1	DOUBLE SEAL PLACED ACCORDING TO THE SPECIAL PROVISIONS
F2	TRIPLE SEAL PLACED ACCORDING TO THE SPECIAL PROVISIONS
T	EXISTING SHOULDER
U	EXISTING ASPHALT

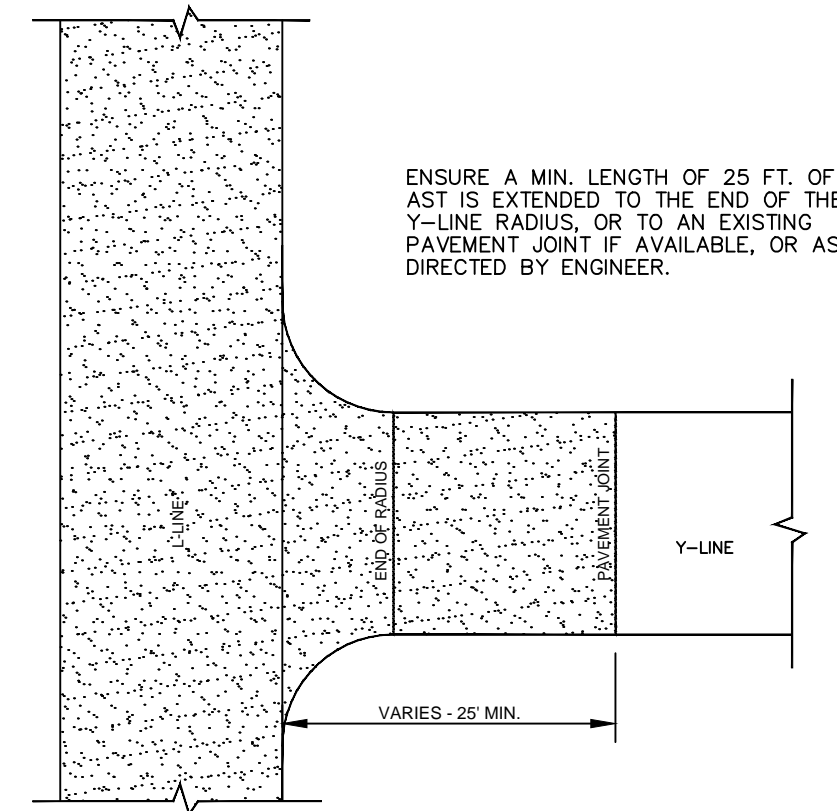

DETAIL 1
Y-LINE INTERSECTION TREATMENT

SIGNING FOR ASPHALT SURFACE TREATMENT

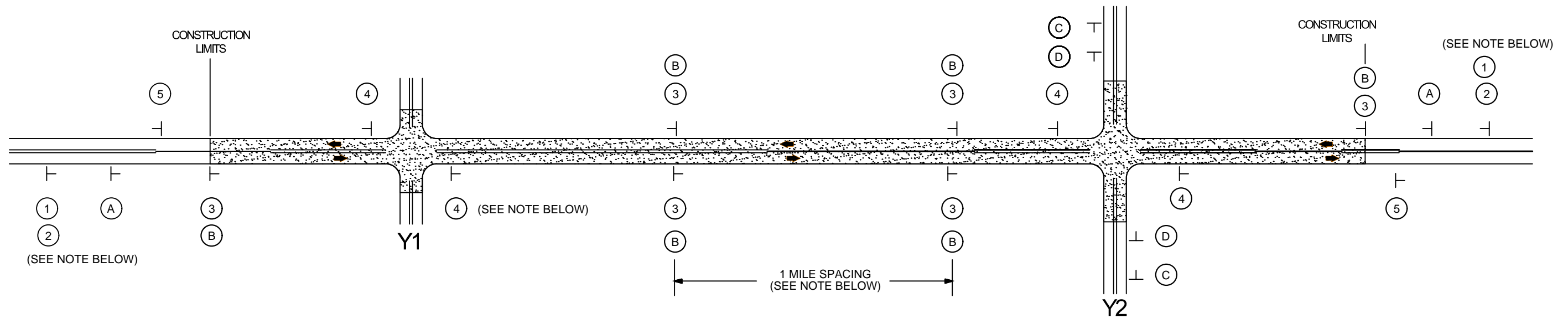

MAINLINE (-L-) SIGNING

-Y- LINE SIGNING

SIGNING NOTES AND PLACEMENT PER DIRECTION	 	<p>PLACE 1000' PRIOR TO BEGINNING OF CONSTRUCTION LIMITS.</p> <p>#2 SIGN ONLY USED WHEN RESURFACING LIMITS ARE 2 OR MORE MILES IN LENGTH. ROUND UP TO NEXT WHOLE NUMBER. (NO FRACTIONAL OR DECIMAL NUMBERS)</p>
	 	<p>ALTERNATE THE FOLLOWING TWO SIGNS: STARTING WITH "LOOSE GRAVEL" (W8-7) FOLLOWED BY "UNMARKED PAVEMENT".</p> <p>PLACE INITIALLY AT THE CONSTRUCTION LIMITS AND SPACED 1 MILE APART THEREAFTER. IF NO -Y- LINES EXIST, PLACE 2ND SET 1/2 MILE FROM THE CONSTRUCTION LIMITS AND THEN SPACE 1 MILE THEREAFTER.</p>
		<p>PLACE 500' PRIOR TO BEGINNING OF CONSTRUCTION LIMITS.</p>
	 	<p>PLACE INITIALLY AT THE CONSTRUCTION LIMITS AND SPACED 1 MILE APART THEREAFTER. IF NO -Y- LINES EXIST, PLACE 2ND SET 1/2 MILE FROM THE CONSTRUCTION LIMITS AND THEN SPACE 1 MILE THEREAFTER. SPEED LIMIT SIGN MAY BE PLACED ON SAME PART AS LOOSE GRAVEL SIGN, IF DESIRED. IF SO, ELIMINATE WORK ZONE SIGN (G20-5aP).</p>
		<p>THESE ARE FOR -Y- LINES THAT ARE "THROUGH" ROADWAYS. DEAD END AND SUBDIVISION ROADS ARE NOT "THROUGH" ROADWAYS. INSTALL 500' +/- FROM EACH -Y- LINE APPROACH AS SHOWN ABOVE. FOR MULTIPLE -Y- LINES THAT ARE SEPARATED BY 0.25 MILES OR LESS, TREAT AS A SINGLE UNIT AND INSTALL WITHIN 500' OF EACH APPROACH. A MAXIMUM OF 2 SIGN SETS PER MILE. DO NOT INSTALL WHEN -Y- LINES ARE WITHIN 0.5 MILES FROM "END ROAD WORK" SIGN.</p>
		<p>PLACE 500' FOLLOWING THE END OF CONSTRUCTION LIMITS.</p>

ADVANCE WARNING PORTABLE SIGNS MAY BE USED IN LIEU OF STATIONARY SIGNS ALONG THE -Y- LINE AS SHOWN BELOW. REMOVE UPON COMPLETION OF WORK EACH DAY. UNDER NO CIRCUMSTANCES SHALL PORTABLE SIGNS BE LEFT IN PLACE WHEN NO CONSTRUCTION ACTIVITY IS OCCURRING, OR WHEN CONTRACTOR IS NOT ON SITE.

PLACED 500' IN ADVANCE OF FLAGGER.

PLACED 250' IN ADVANCE OF FLAGGER.

NO REQUIRED STATIONARY SIGNING FOR THE FOLLOWING -Y- LINE CONDITIONS:

- SUBDIVISION ROADS
- DEAD END ROADS

LEGEND

└ STATIONARY SIGN

➔ DIRECTION OF TRAFFIC FLOW

NOTE:
IT IS THE CONTRACTOR'S RESPONSIBILITY TO ENSURE THE PROPER PLACEMENT AND LOCATION OF WORK ZONE SIGNING PER THE STANDARD DRAWING. NCDOT HAS THE RIGHT TO INSPECT THE PLANNED LOCATIONS AND REQUIRE ADJUSTMENT BY THE CONTRACTOR, AS NEEDED, OR AS DIRECTED BY THE ENGINEER.

OR OTHER ENGINEER APPROVED METHOD

ADVANCE WARNING SIGNS
FOR
ASPHALT SURFACE
TREATMENTS

Schedule of Quantities

Date: 12/21/2016
 Contract #: DF00149
 WBS: Double Seals - 2017CPT.06.09.20782.1 (DF00149A)
 Triple Seals - 2017CPT.06.09.20782.2 (DF00149B)

Division : 6
 County: Robeson
 Description: AST - Double & Triple Seals

Map	SR	From	Begin MP	To	End MP	CL Length (Mile)	Width (Ft.)	Quantity (SY)	Treatment	WZ Signs (SF)	Emulsion (GAL)
1	SR 2225	NC 130	3.050	NC 130	14.171	11.121	20	130,486	Double	1,779	79,596
2	SR 2246	SR 2225	0.690	SR 2247	4.013	1.443	20	16,931	Double	231	10,328
3	SR 2249	SR 2247	0.000	SR 2251	0.850	0.850	20	9,973	Double	136	6084
4	SR 2250	SR 2247	0.000	SR 2251	0.900	0.900	20	10,560	Double	144	6442
5	SR 2251	SR 2225	0.000	SR 2249	3.120	3.120	18	32,947	Double	499	20098
6	SR 2252	SR 2256	0.860	CDS	1.600	0.740	20	8,683	Double	118	5297
7	SR 2255	SR 2254	0.000	SR 2264	8.280	8.280	20	97,152	Double	1325	59263
8	SR 2256	SR 2225	0.000	NC 904	5.140	5.140	18	54,278	Double	822	33110
9	SR 2257	NC 904	0.000	DEAD END	0.500	0.500	20	5,867	Double	80	3,579
10	SR 2258	NC 904	1.690	SR 2255	3.590	1.900	18	20,064	Double	304	12,239
11	SR 2259	SR 2255	0.000	SR 2258	1.040	1.040	18	10,982	Double	166	6699
12	SR 2260	SR 2255	0.000	SR 2225	2.060	2.060	18	21,754	Double	330	13270
13	SR 2261	SR 2255	0.000	SR 2260	0.590	0.590	20	6,923	Double	94	4,223
14	SR 2262	SR 2225	0.000	NC 41	2.730	2.730	20	32,032	Double	437	19,540
15	SR 2263	SR 2225	0.000	SR 2255	0.579	0.579	20	6,794	Double	93	4,144
16	SR 2264	NC130	0.000	SR 2269	3.110	3.110	18	32,842	Double	498	20,034
17	SR 2265	SR 2264	0.000	NC 130	0.590	0.590	20	6,923	Double	94	4223
18	SR 2266	SR 2264	0.000	NC 130	1.120	1.120	18	11,827	Double	179	7,214
19	SR 2267	NC130	0.000	SR 2269	1.700	1.700	18	17,952	Double	272	10,951
20	SR 2268	NC 130	0.000	SR 2225	1.470	1.470	20	17,248	Double	235	10,521
21	SR 2269	SR 2225	0.000	SR 2272	1.480	1.480	18	15,629	Double	237	9534
22	SR 2271	SR 2225	0.000	SR 2269	1.890	1.890	18	19,958	Double	302	12174
23	SR 2272	SR 2269	0.000	SR 2225	2.240	2.240	18	23,654	Double	358	14429
24	SR 2273	SR 2272	0.000	SR 2276	1.020	1.020	20	11,968	Double	163	7300
25	SR 2274	SR 2272	0.000	SR 2225	1.330	1.330	18	14,045	Double	213	8567
26	SR 2275	SR 2276	0.000	SR 2274	0.670	0.670	20	7,861	Double	107	4795
27	SR 2276	SR 2225	0.000	SR 2264	2.690	2.690	18	28,406	Double	430	17,328
28	SR 2288	SR 2225	0.000	DEAD END	0.233	0.233	20	2,734	Double	37	1,668
29	SR 2298	NC 41	0.000	NC 130	1.120	1.120	18	11,827	Double	179	7,214
30	SR 2312	US 74	0.000	DEAD END	0.118	0.118	20	1,385	Double	19	845
31	SR 2333	SR 2255	0.000	CDS	0.410	0.410	20	4,811	Double	66	2,935
SUBTOTALS - DOUBLE SEALS:						62.184		694,496		9,947	423,644
32	SR 2247	SR 2246	0.000	SR 2250	1.510	1.510	20	17,717	Triple	242	15,768
SUBTOTALS - TRIPLE SEALS:						1.510		17,717		242	15,768
TOTALS:						63.694		712,213		10,189	439,412